

MATERIALI ESISTENTI

Si rimanda alle relazione tecnica generale.



COMUNE DI GIOVINAZZO

Città Metropolitana di BARI

Assessorato OO.PP. e Lavori Pubblici

Assessorato allo Sport

SETTORE GESTIONE DEL TERRITORIO



Lavori di adeguamento, messa a norma, miglioramento energetico e sismico della Casa di Riposo "San Francesco"

Progetto di fattibilità		Art. 23 co. 1-5-6	D. Lgs. 18 Apr. 2016 n° 50	Proposta di intervento da realizzare con risorse rivenienti dal FSC 2007-2013 - D.G.R. 629/2015
Progetto definitivo		Art. 23 co. 1-7	D. Lgs. 18 Apr. 2016 n° 50	
Progetto esecutivo	X	Art. 23 co. 1-8	D. Lgs. 18 Apr. 2016 n° 50	

Elaborato grafico	TAV. n°	data
Titolo	S10	18 Dicembre 2016
Scala: varie		
ARMATURA TRAVI PRIMO PIANO stato dei luoghi		

ELABORAZIONE A CURA DEL SETTORE GESTIONE DEL TERRITORIO - SERVIZIO LL.PP.

PROGETTO	RESPONSABILE UNICO DEL PROCEDIMENTO Ing. Cesare TREMATORE
----------	--------------------------------------------------------------

ARMATURA TRAVE 10-6 , 40-36 (piano primo)

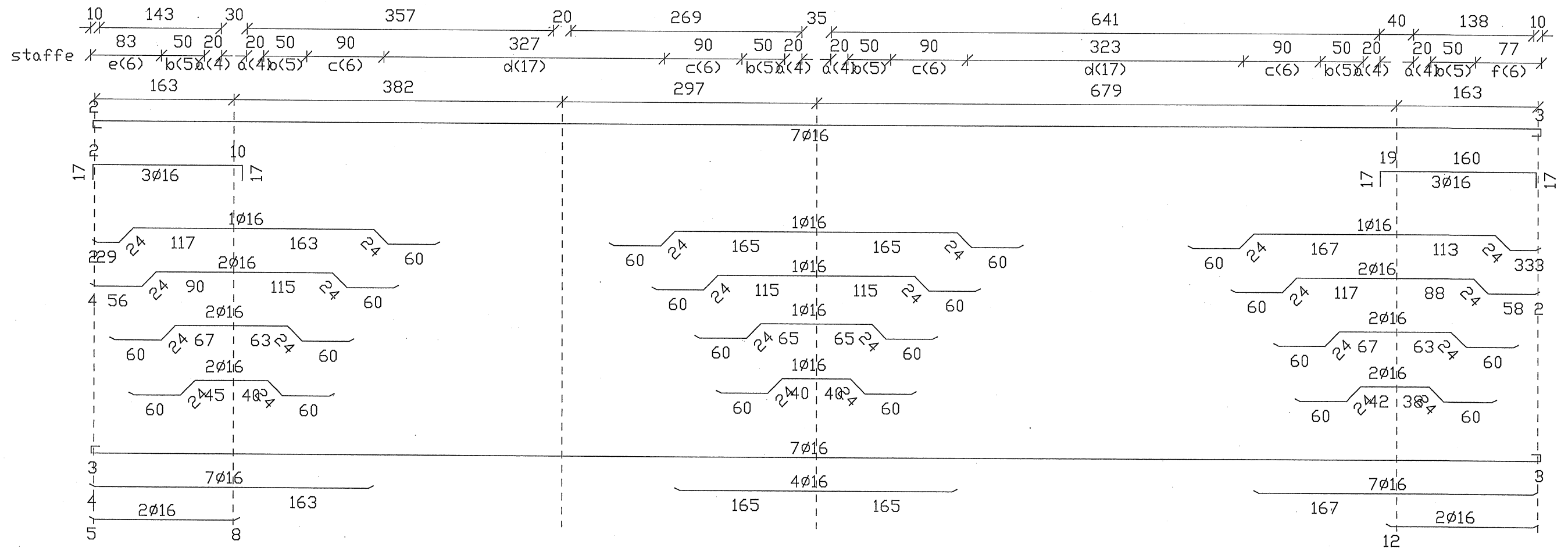
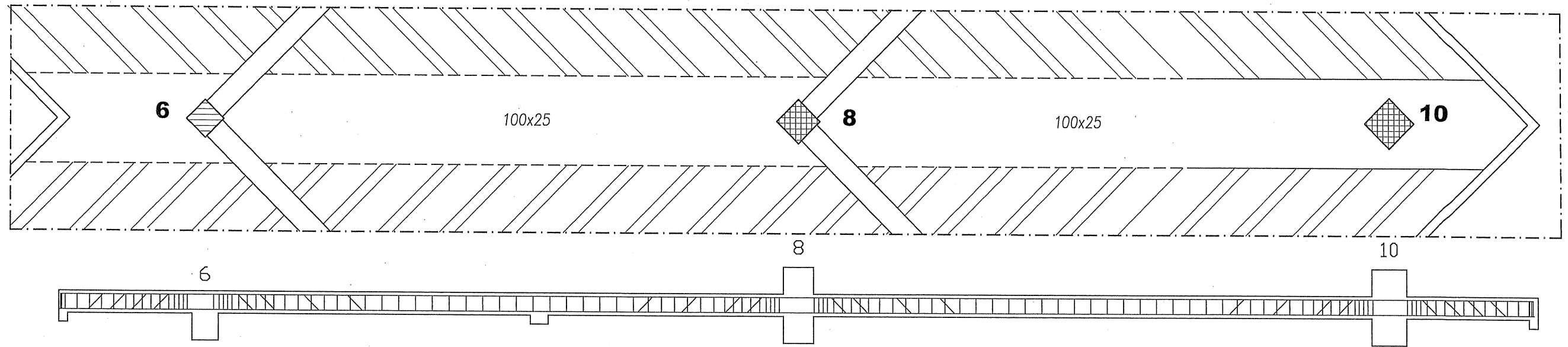

ARMATURA TRAVE 10-6, 40-36 (piano primo)

sezione scala 1:20

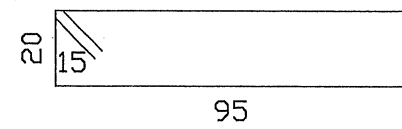
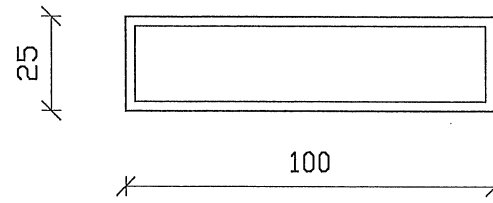

- a) st.Ø8/5
 - b) st.Ø8/10
 - c) st.Ø8/15
 - d) st.Ø8/19
 - e) st.Ø8/14
 - f) st.Ø8/13
- L=260

ARMATURA TRAVE 25-21 (piano primo)

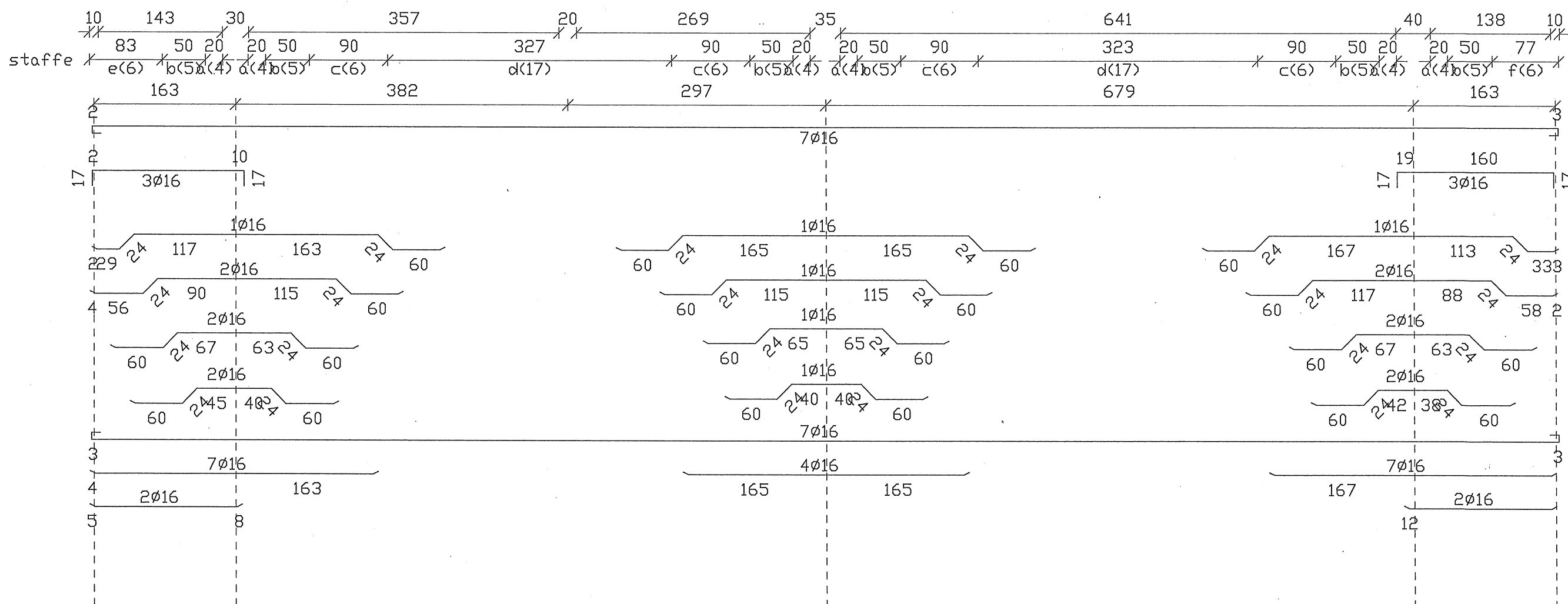
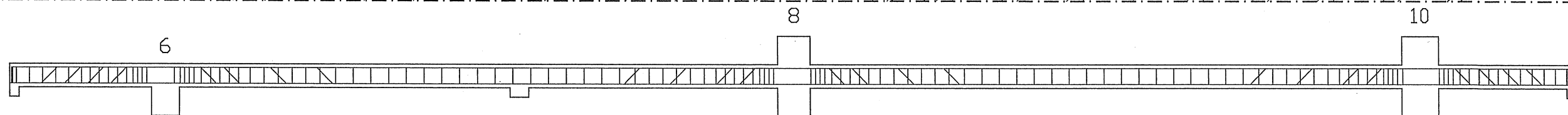
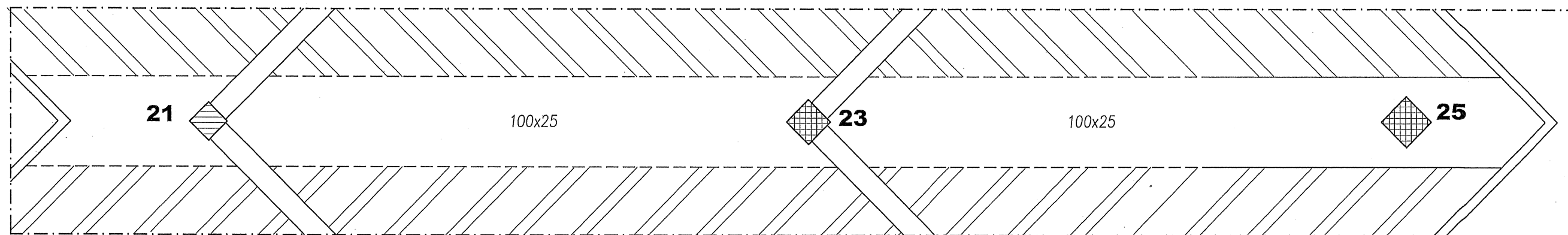

ARMATURA TRAVE 25-21 (piano primo)

sezione scala 1:20

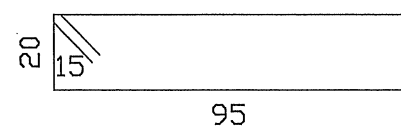
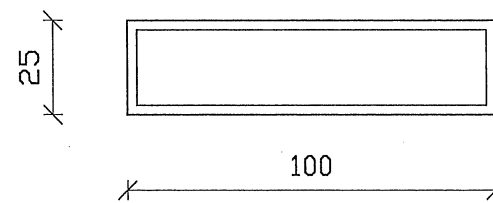

- a) st.Ø8/5
 - b) st.Ø8/10
 - c) st.Ø8/15
 - d) st.Ø8/19
 - e) st.Ø8/14
 - f) st.Ø8/13
- L=260

ARMATURA TRAVE 31-33 , 13-15 (piano primo)

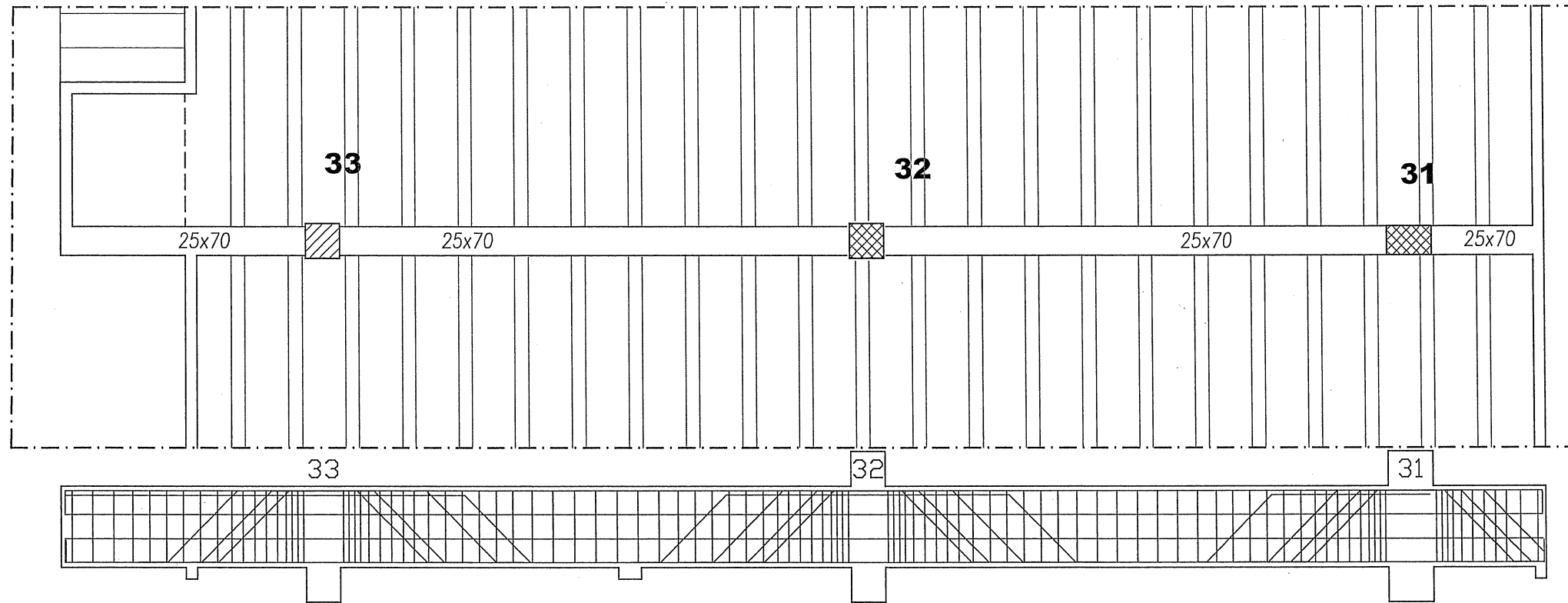

sezione scala 1:20

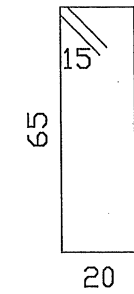
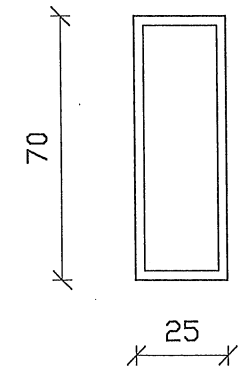

- a) st.Ø6/5
- b) st.Ø6/10
- c) st.Ø6/15
- d) st.Ø6/19
- L=200

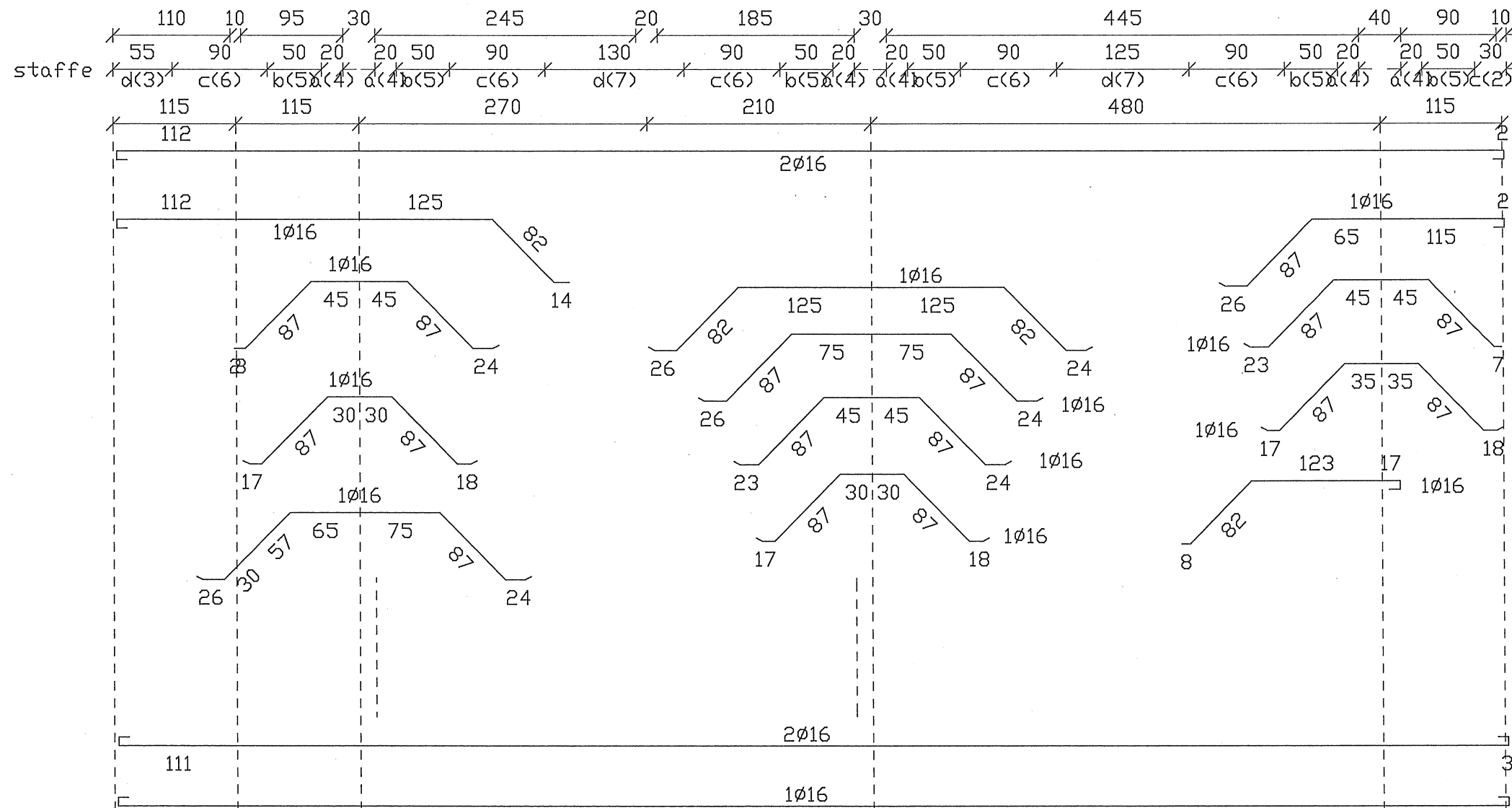

ARMATURA TRAVE 4-6 , 42-36 (piano primo)

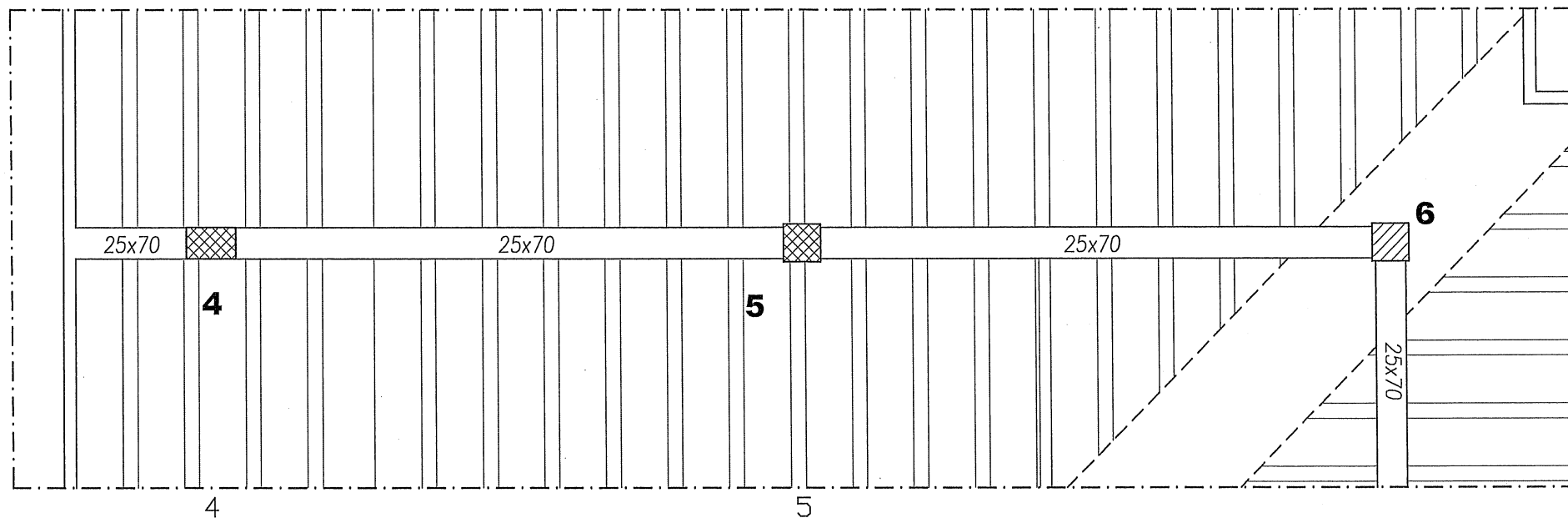

sezione scala 1:20

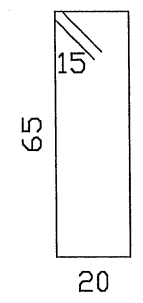
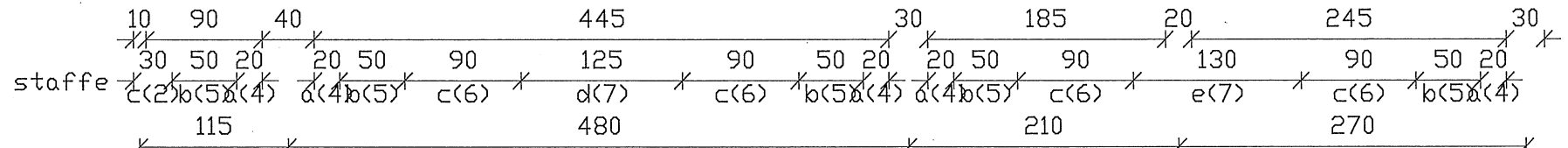
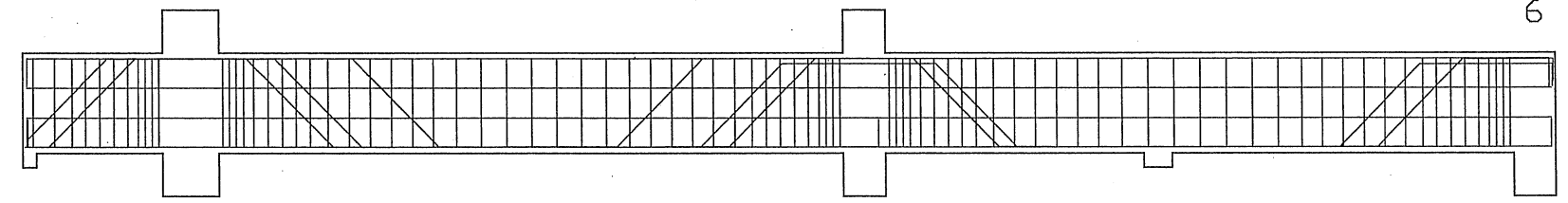
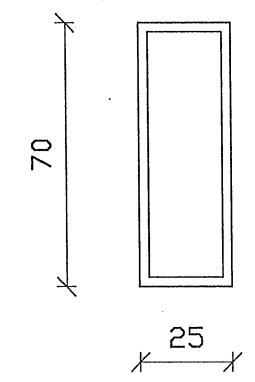

- a) st.Ø6/5
- b) st.Ø6/10
- c) st.Ø6/15
- d) st.Ø6/18
- e) st.Ø6/19
- L=200

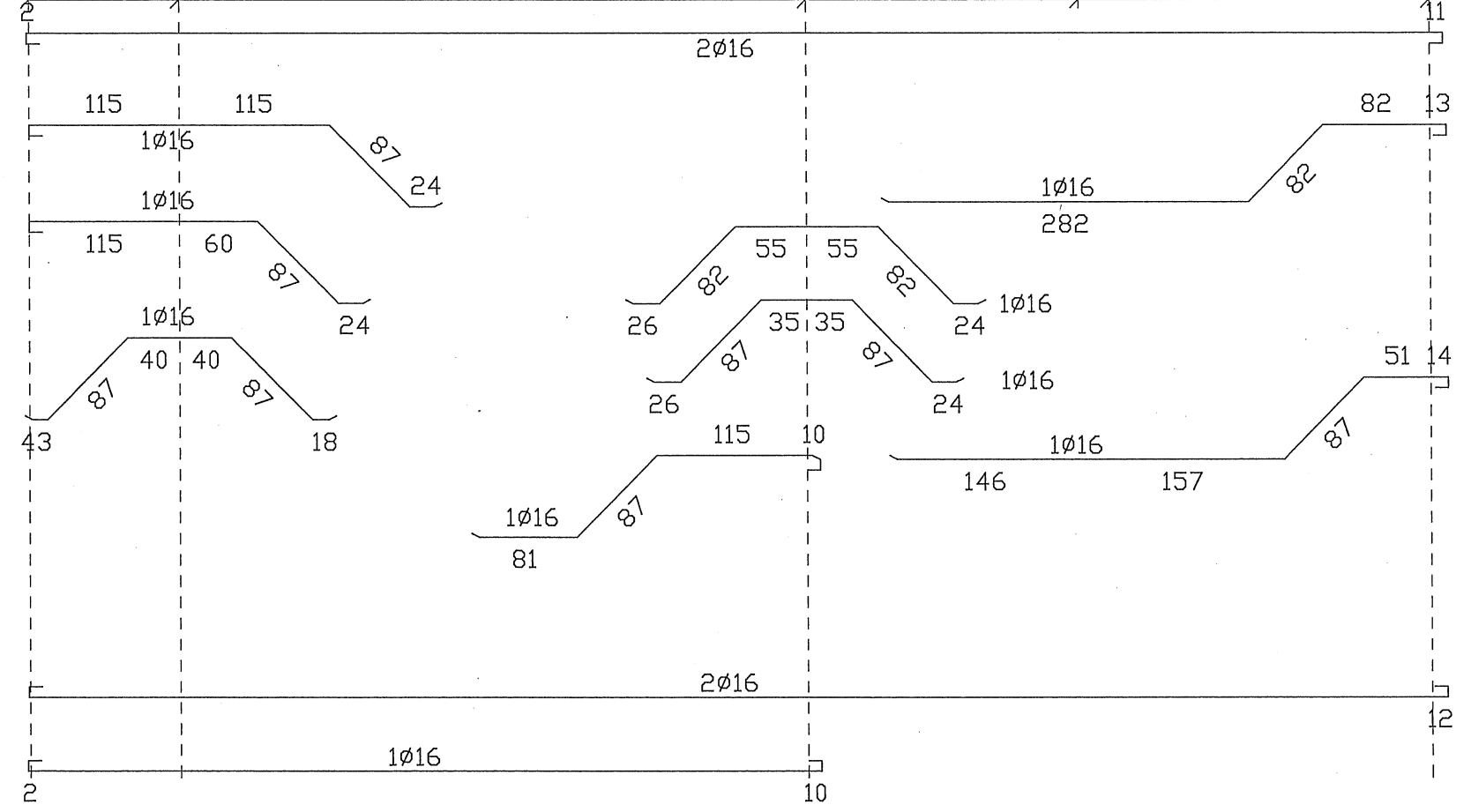

ARMATURA TRAVE 12-6 , 19-21 , 27-21 , 34-36 (piano primo)

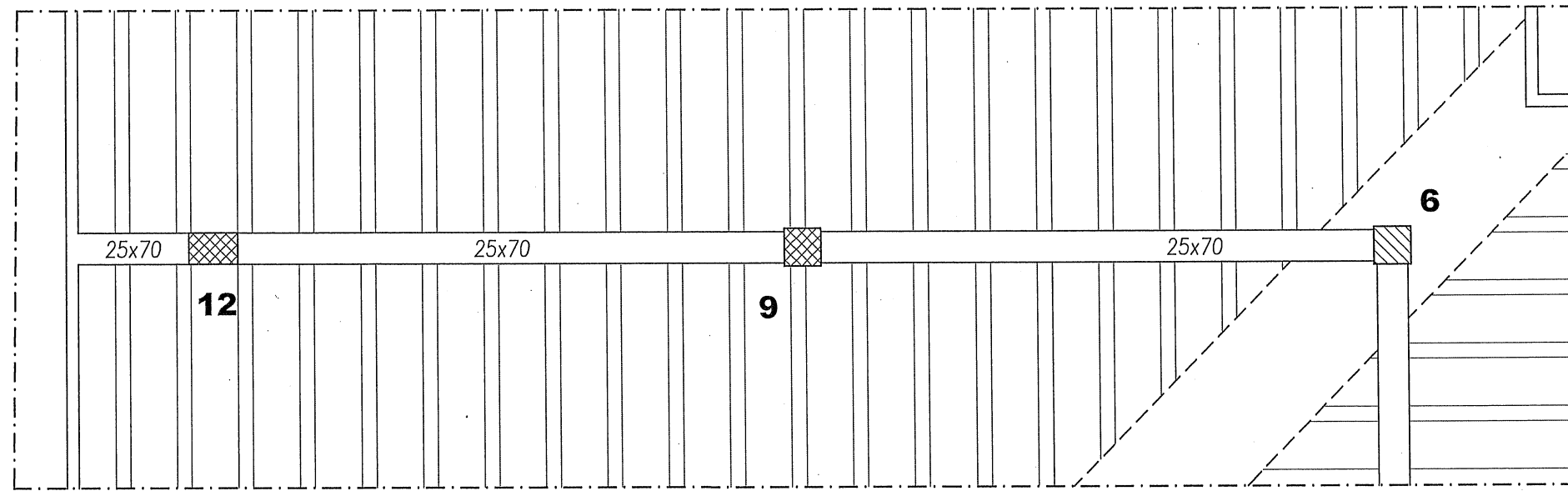

sezione scala 1:20

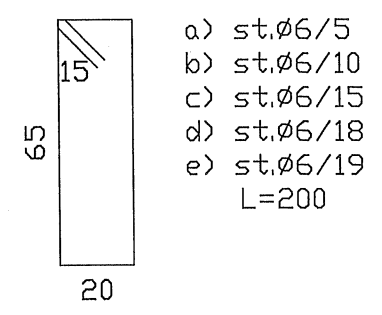
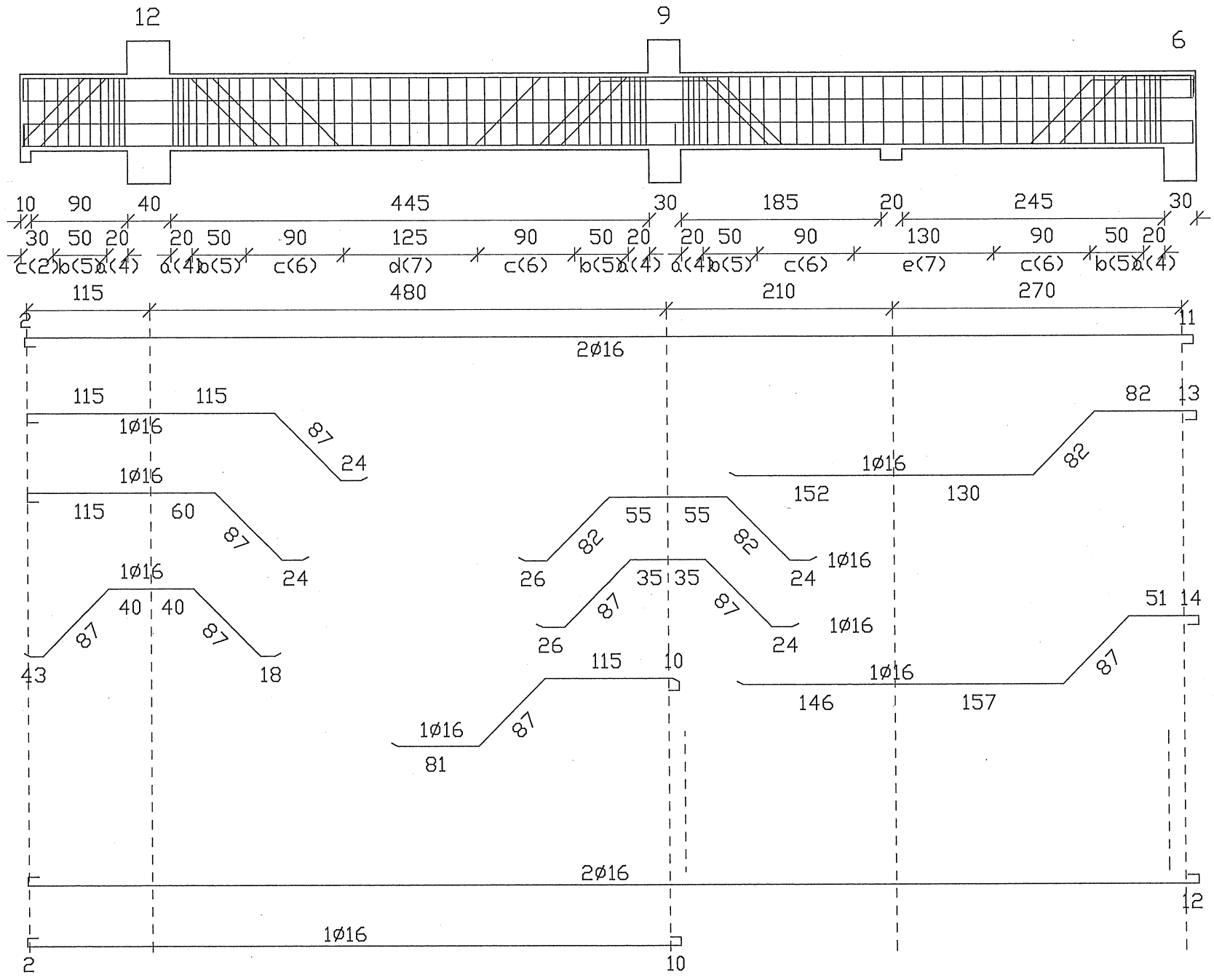
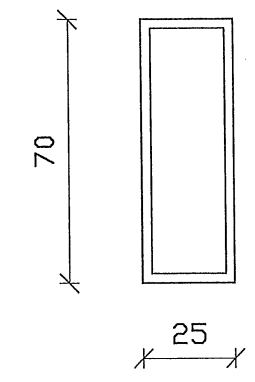

- a) st.Ø6/5
- b) st.Ø6/10
- c) st.Ø6/15
- d) st.Ø6/18
- e) st.Ø6/19
- L=200

ARMATURA TRAVE 7-8 , 11-8 , 22-23 , 26-23 , 37-38 , 41-38 (piano primo)

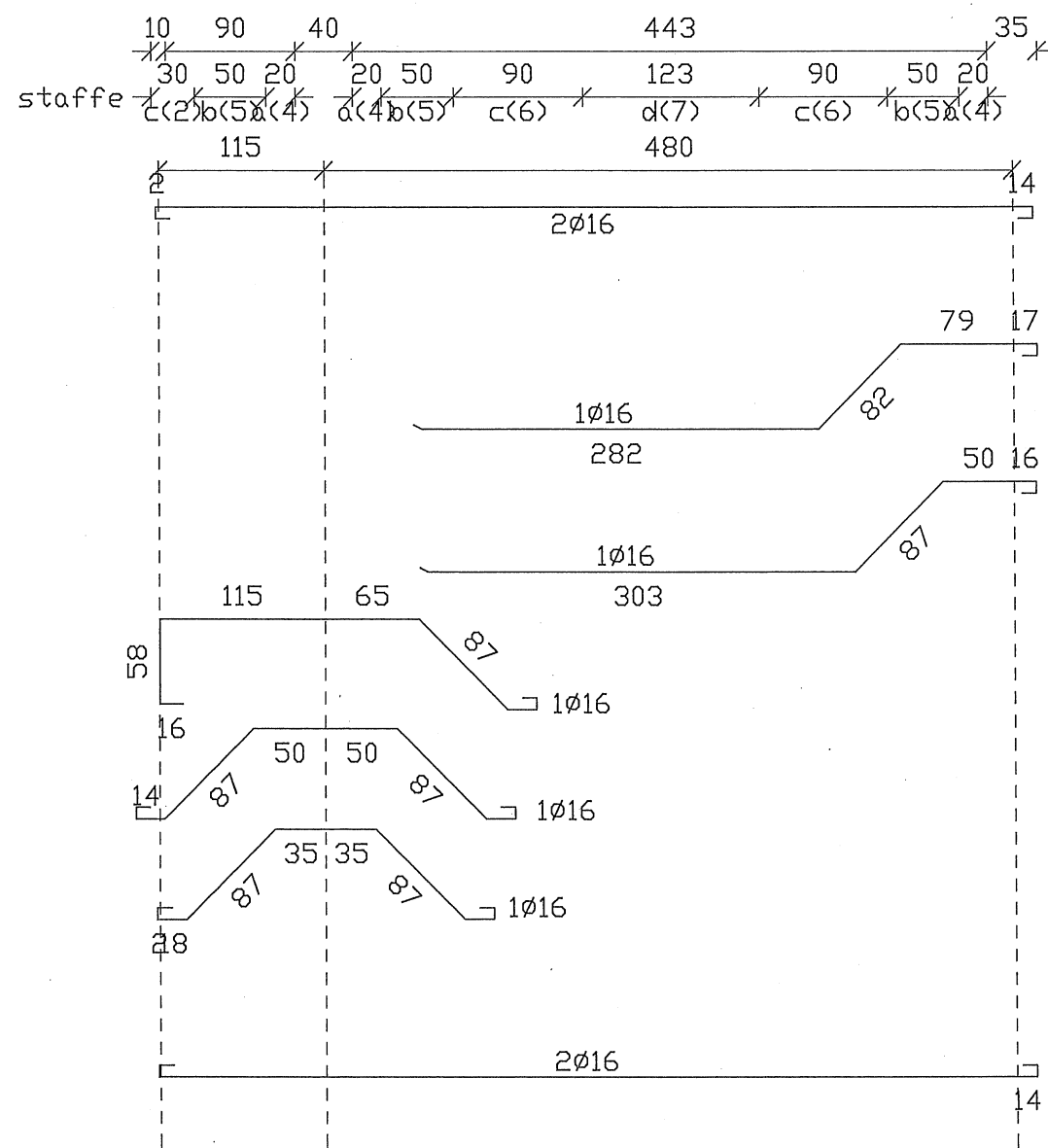
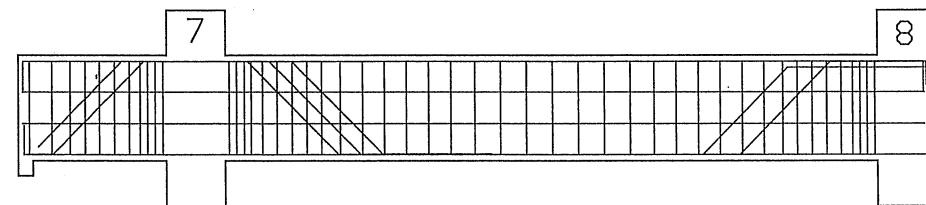
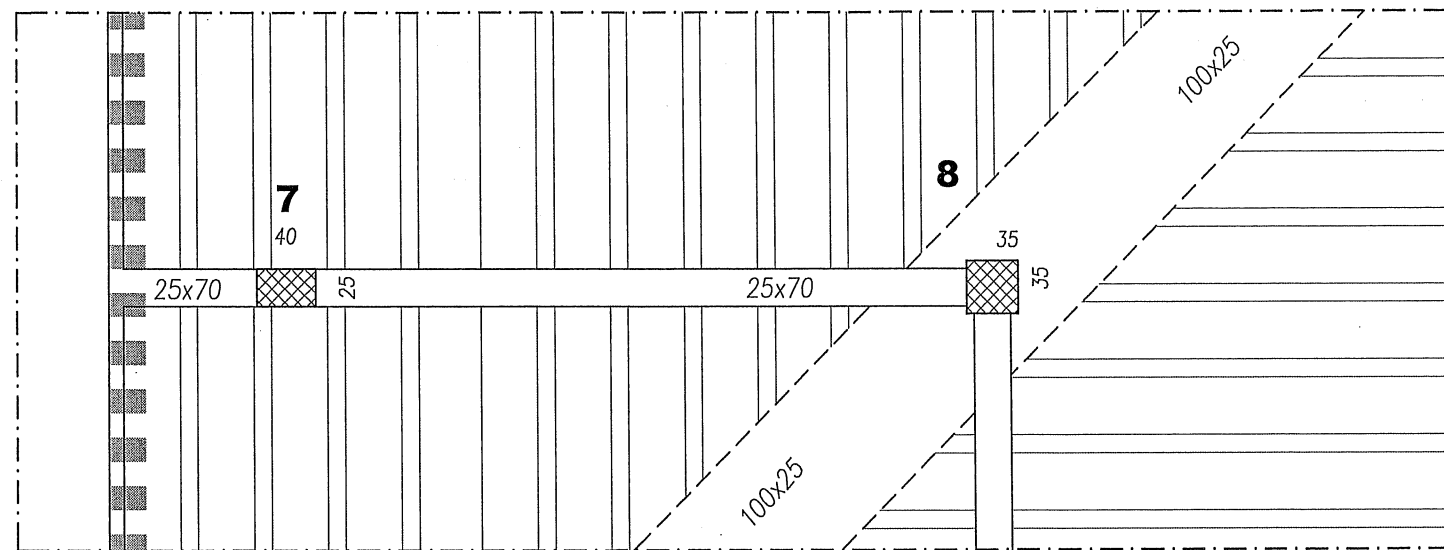

sezione scala 1:20

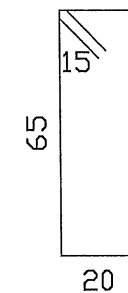
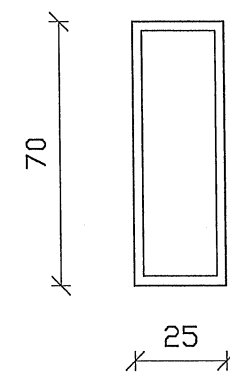

- a) st.∅6/5
- b) st.∅6/10
- c) st.∅6/15
- d) st.∅6/18
- L=200

ARMATURA TRAVE 61-50 (piano primo)

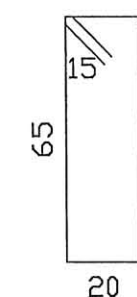
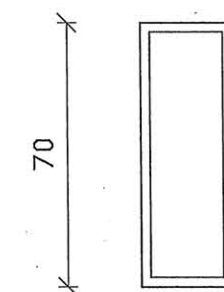
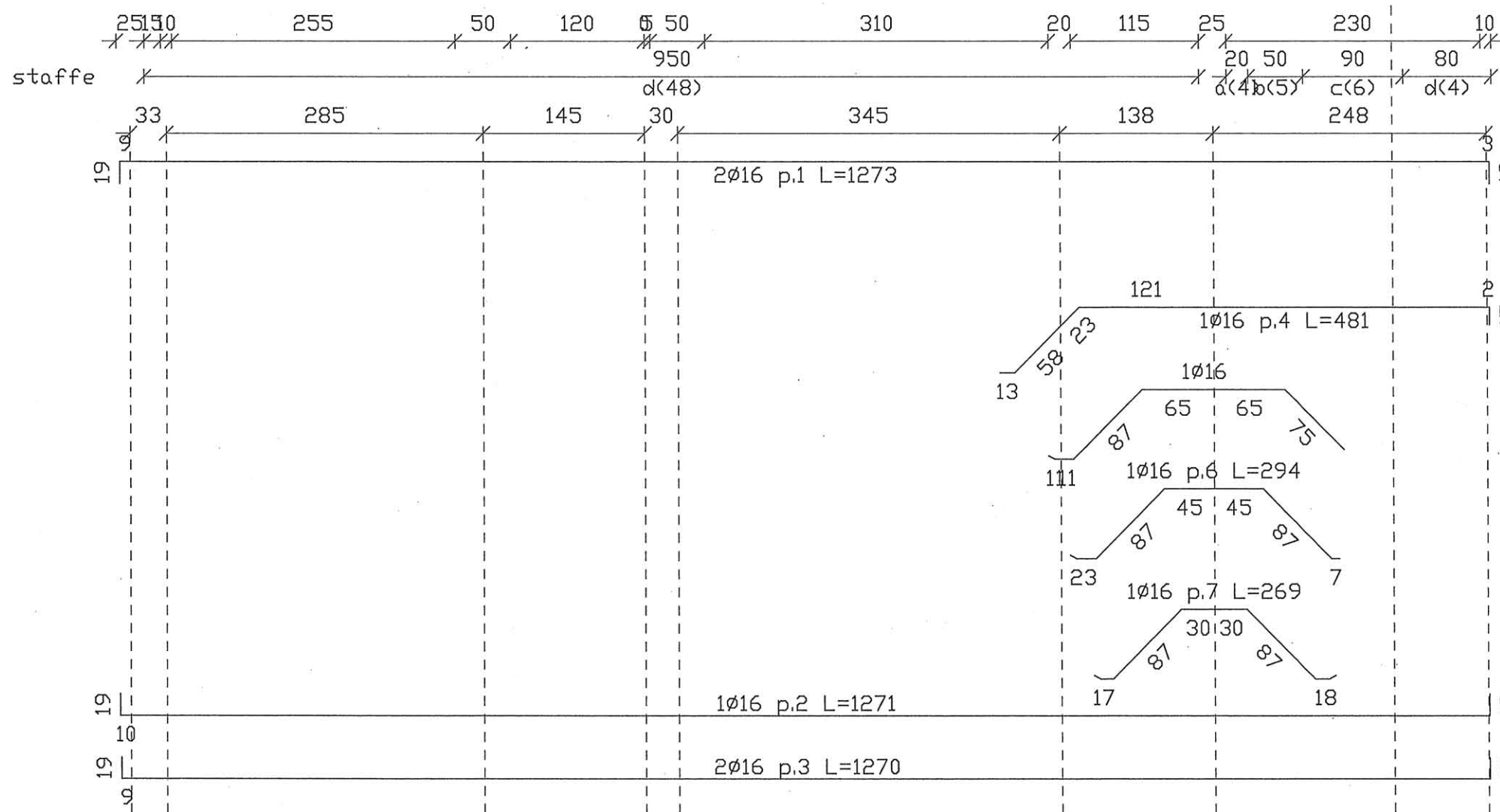
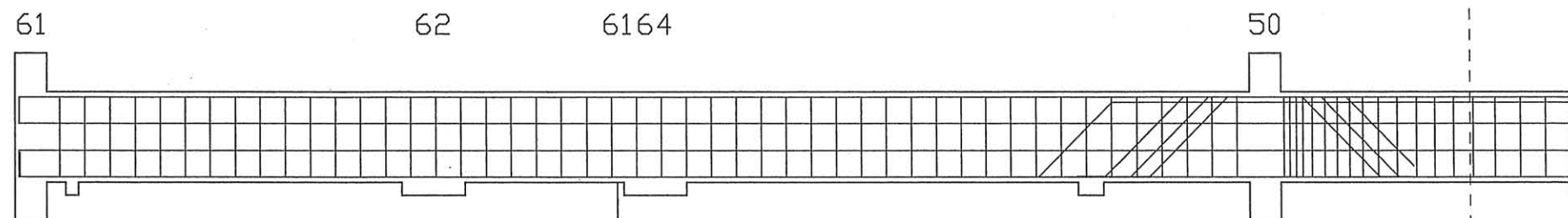
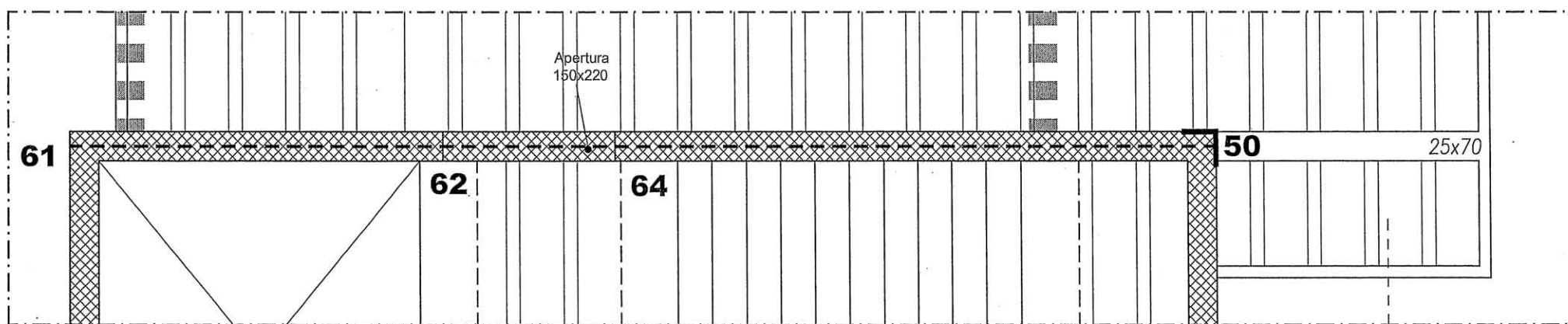

- a) st.∅6/5
- b) st.∅6/10
- c) st.∅6/15
- d) st.∅6/20
L=200

ARMATURA TRAVE 58-54 (piano primo)

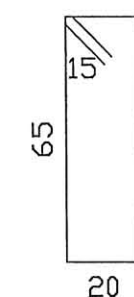
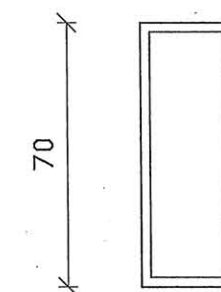
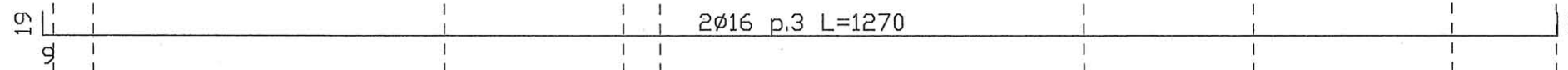
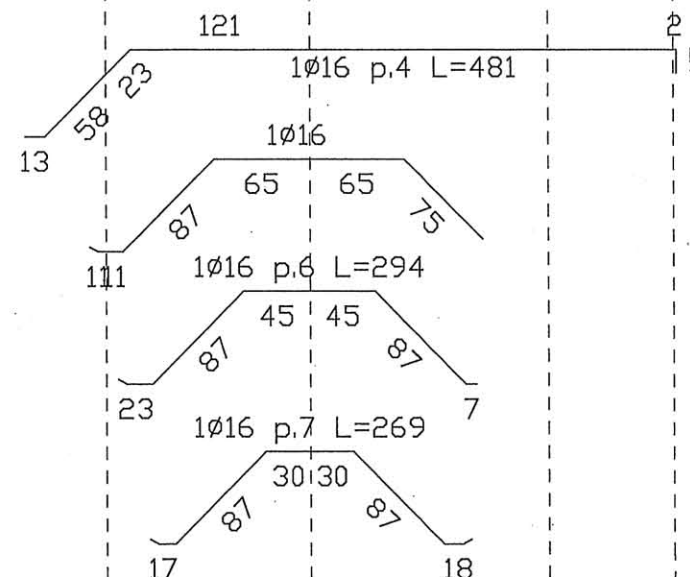
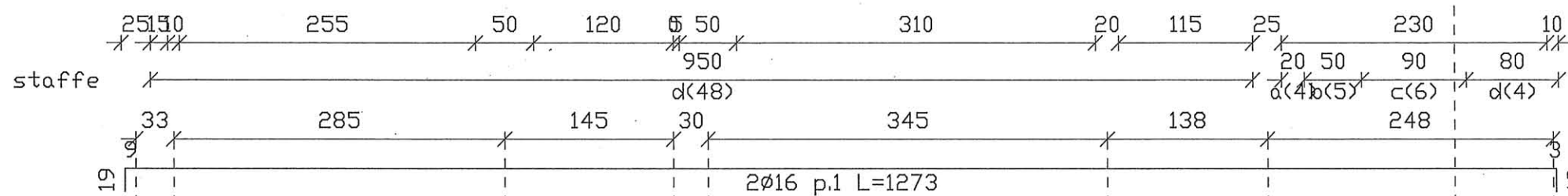
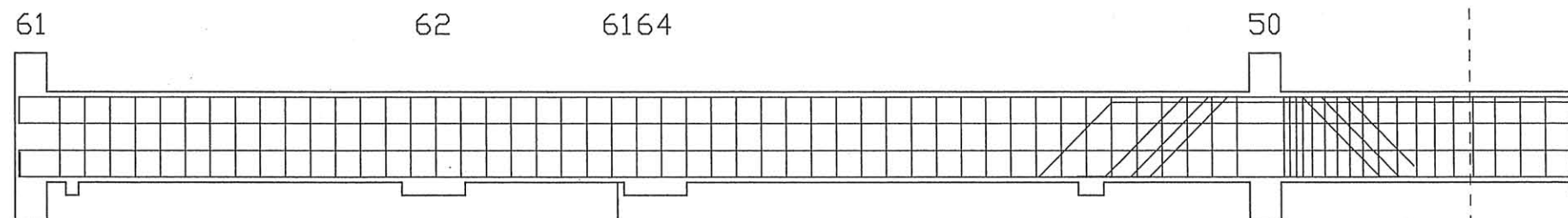
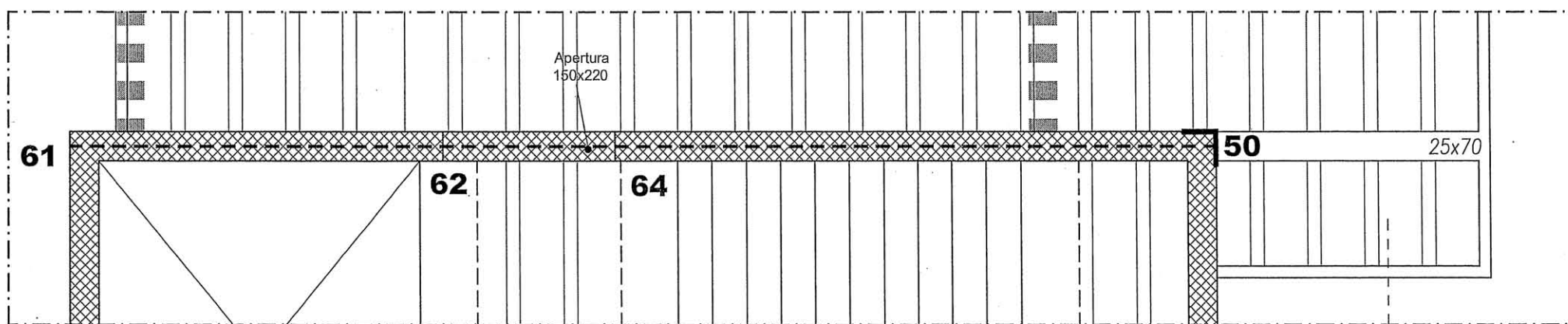

- a) st.∅6/5
- b) st.∅6/10
- c) st.∅6/15
- d) st.∅6/20
L=200

ARMATURA TRAVE 1-3 , 16-18 , 28-30 (piano primo)

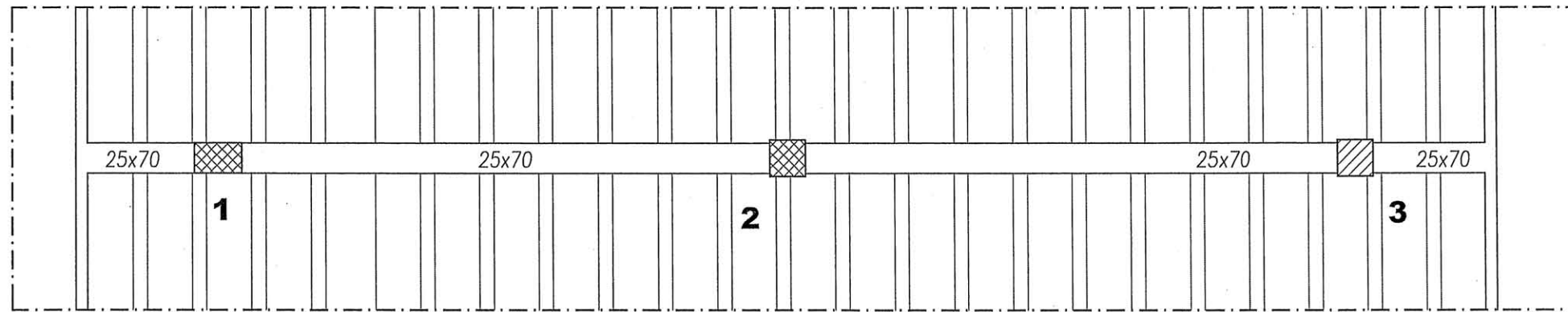

sezione scala 1:20

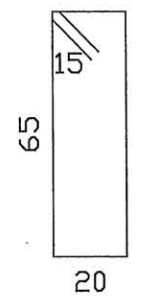
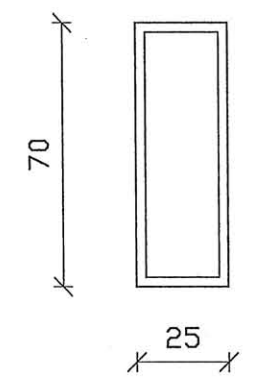
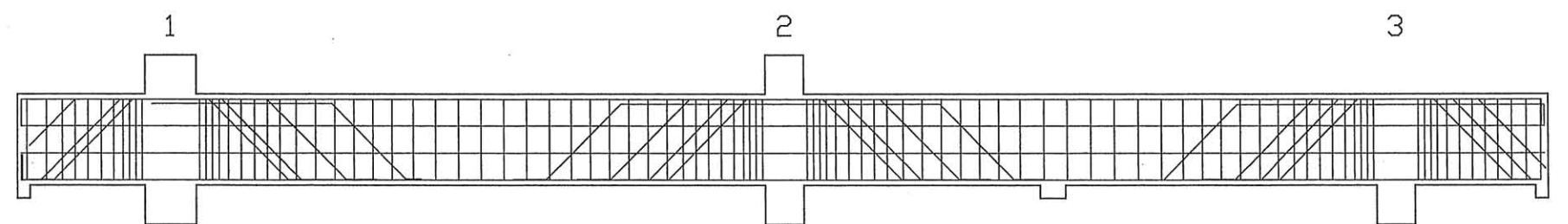

- a) st. ϕ 6/5
- b) st. ϕ 6/10
- c) st. ϕ 6/15
- d) st. ϕ 6/18
- e) st. ϕ 6/12
- f) st. ϕ 6/19
- L=200

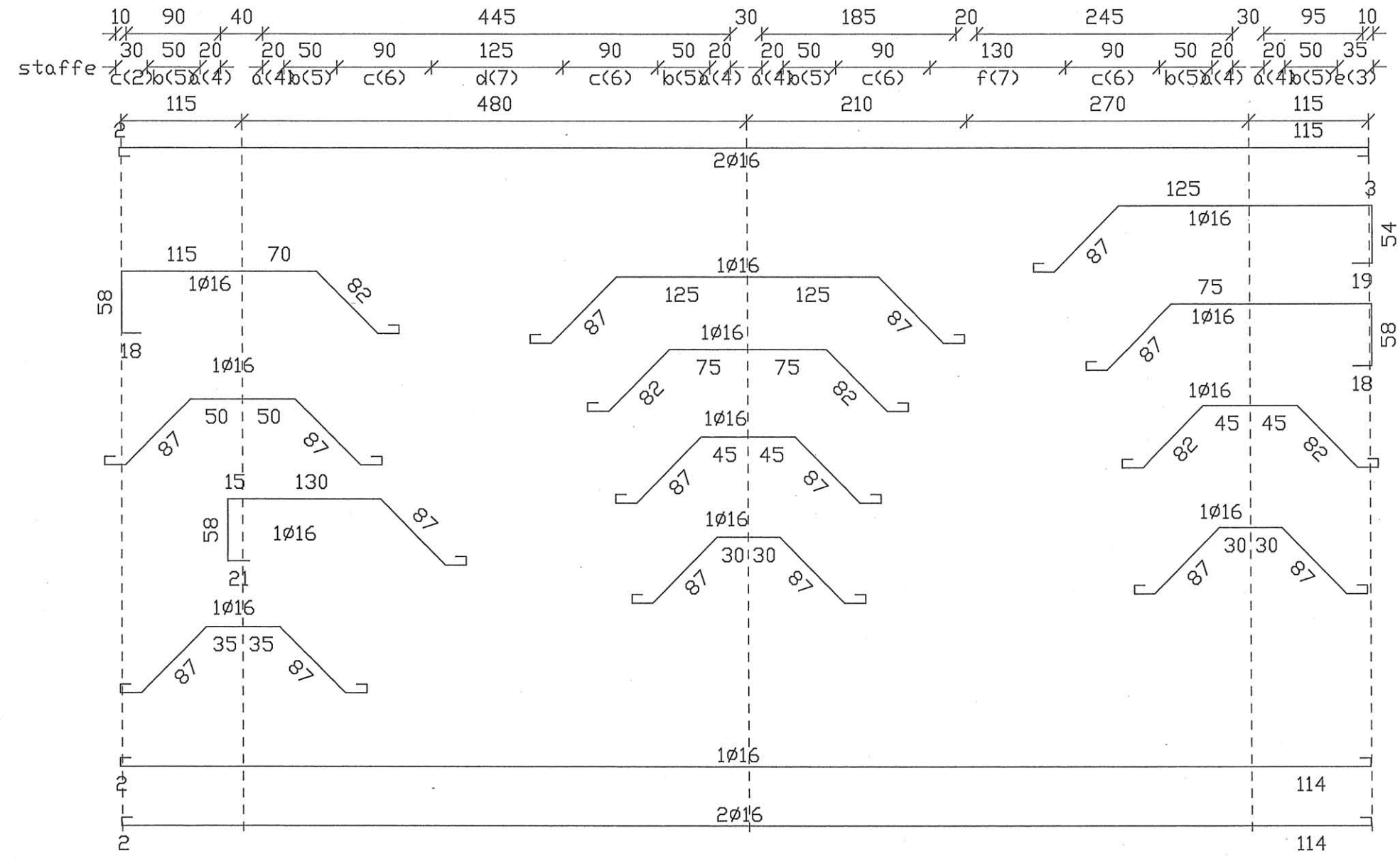

ARMATURA TRAVE 43-45 (piano primo)

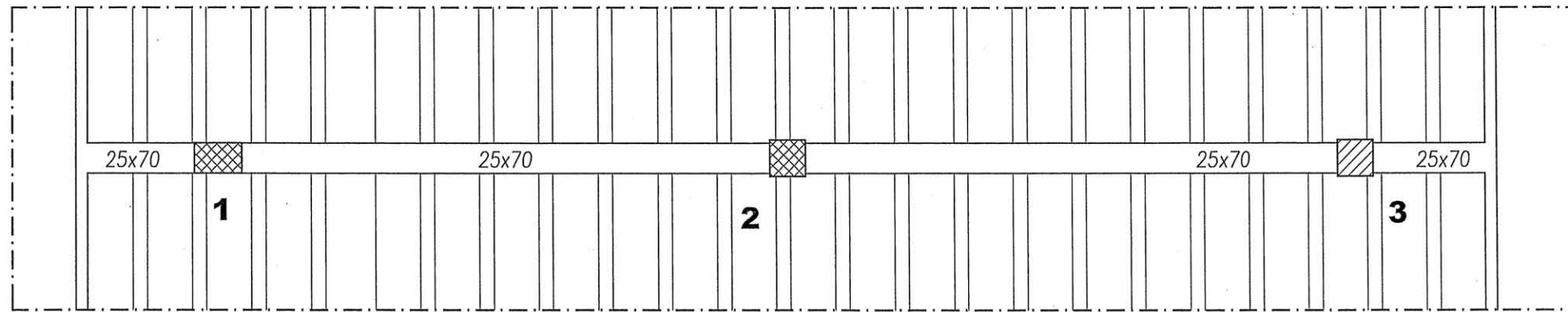

sezione scala 1:20

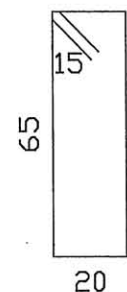
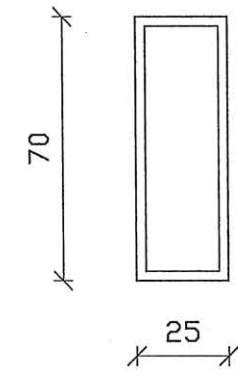
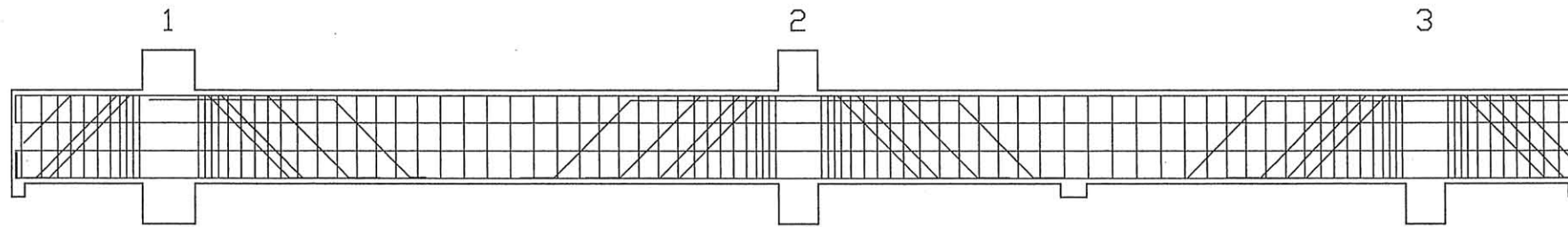

- a) st. ϕ 6/5
- b) st. ϕ 6/10
- c) st. ϕ 6/15
- d) st. ϕ 6/18
- e) st. ϕ 6/12
- f) st. ϕ 6/19
- L=200

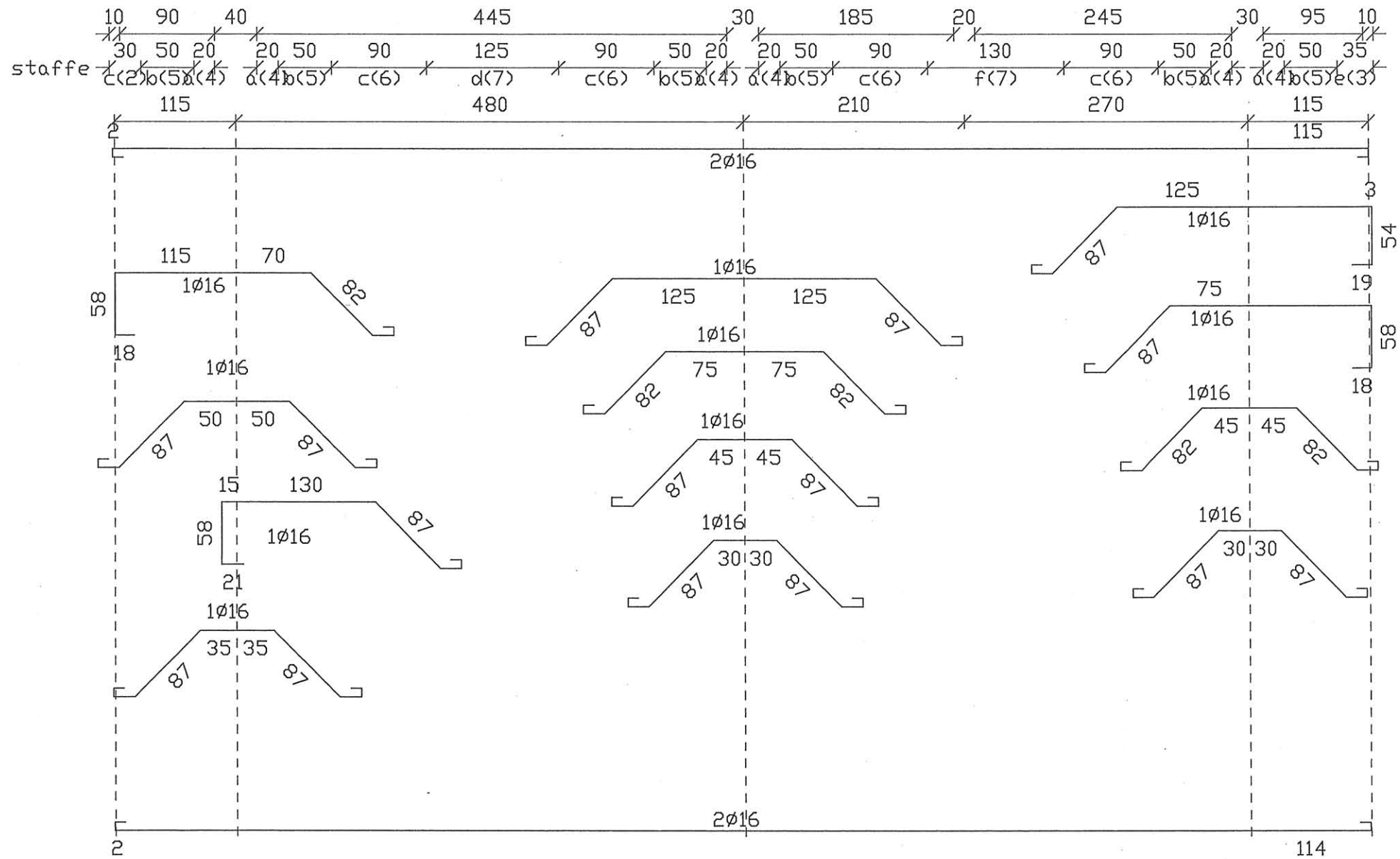

elab.:

TAV. 18bis